

AERODROME CHART - ICAO	N 11 08 59 W 060 49 56	AERODROME ELEV 38	CROWN POINT GROUND - 121.7 CROWN POINT TOWER - 118.4 PIARCO APPROACH - 119.0	DIMENSIONS IN FEET (METRES) ELEVATIONS IN FEET BEARINGS ARE MAGNETIC	CROWN POINT (TTCP) SCARBOROUGH, TOBAGO
------------------------	---------------------------	-------------------	--	--	---

VAR 14° W
(2000)

RESTRICTIONS
 -- NO VFR FLIGHTS PERMITTED AT NIGHT.
 -- RWY 11 AND 29 RIGHT HAND TRAFFIC PATTERN.
TAXI/PARKING:
 -- MEDIUM /HEAVY TURBO JET AIRCRAFT MUST BE TOWED OUT PRIOR TO ENGINE START.
 --COMMERCIAL TURBO PROP AND PISTON AIRCRAFT MUST SHUTDOWN ENGINES DURING INTRANSIT STOPS.

CAUTION
 --BIRDS ON APPROACH TO RWY 11.

CHANGES
 ADJUSTED APRON STRENGTH, ARP AND THR COORS RESOLUTION.
 INCLUDED NEW PARKING POSITIONS WITH RESTRICTIONS AND NEW NDB, LLZ AND DME.
 REMOVED 'GROOVED ASPHALT' FROM TABLE

AIRCRAFT PARKING		
SPOT	COORDINATES	REMARKS
1	N11 09 06.95 W060 50 18.52	FOR HEAVY AIRCRAFT TO B747- 400. TWO FUEL PITS
2	N11 09 07.09 W060 50 20.52	FOR MEDIUM AIRCRAFT UP TO DASH 8. TWO FUEL PITS
3	N11 09 07.20 W060 50 22.00	FOR MEDIUM AIRCRAFT UP TODASH 8
4	N11 09 07.34 W060 50 24.01	FOR HEAVY AIRCRAFT UP TO B747-400. TWO FUEL PITS
5	N11 09 07.14 W060 50 26.07	FOR MEDIUM AIRCRAFT UP TO DASH 8.
6	N11 09 07.23 W060 50 27.27	FOR MEDIUM AIRCRAFT UP TO DASH 8.
7	N11 09 07.33 W060 50 29.34	FOR HEAVY AIRCRAFT UP TO B747-400. ALSO PARKING AREA FOR GA AIRCRAFT/HELICOPTERS. CAN HOLD UP TO SIX (6) SMALL ACFT ALL ORIENTED WEST/EAST. MEDIUM AND HEAVY ACFT WILL NOT BE ACCOMMODATED IN THIS SPOT WHEN USED FOR SMALL ACFT PARKING.

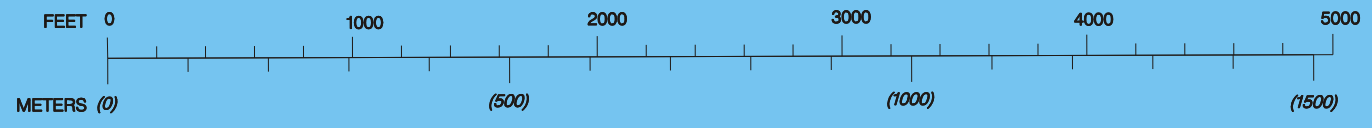
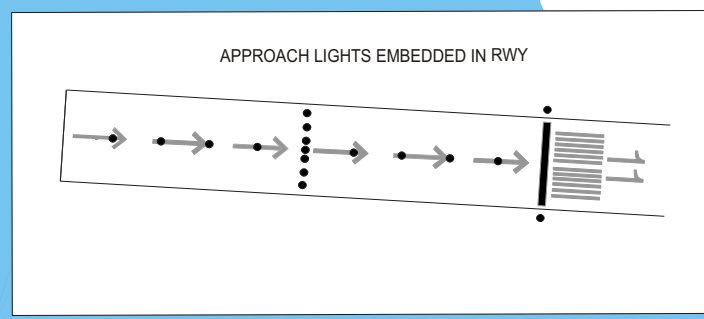
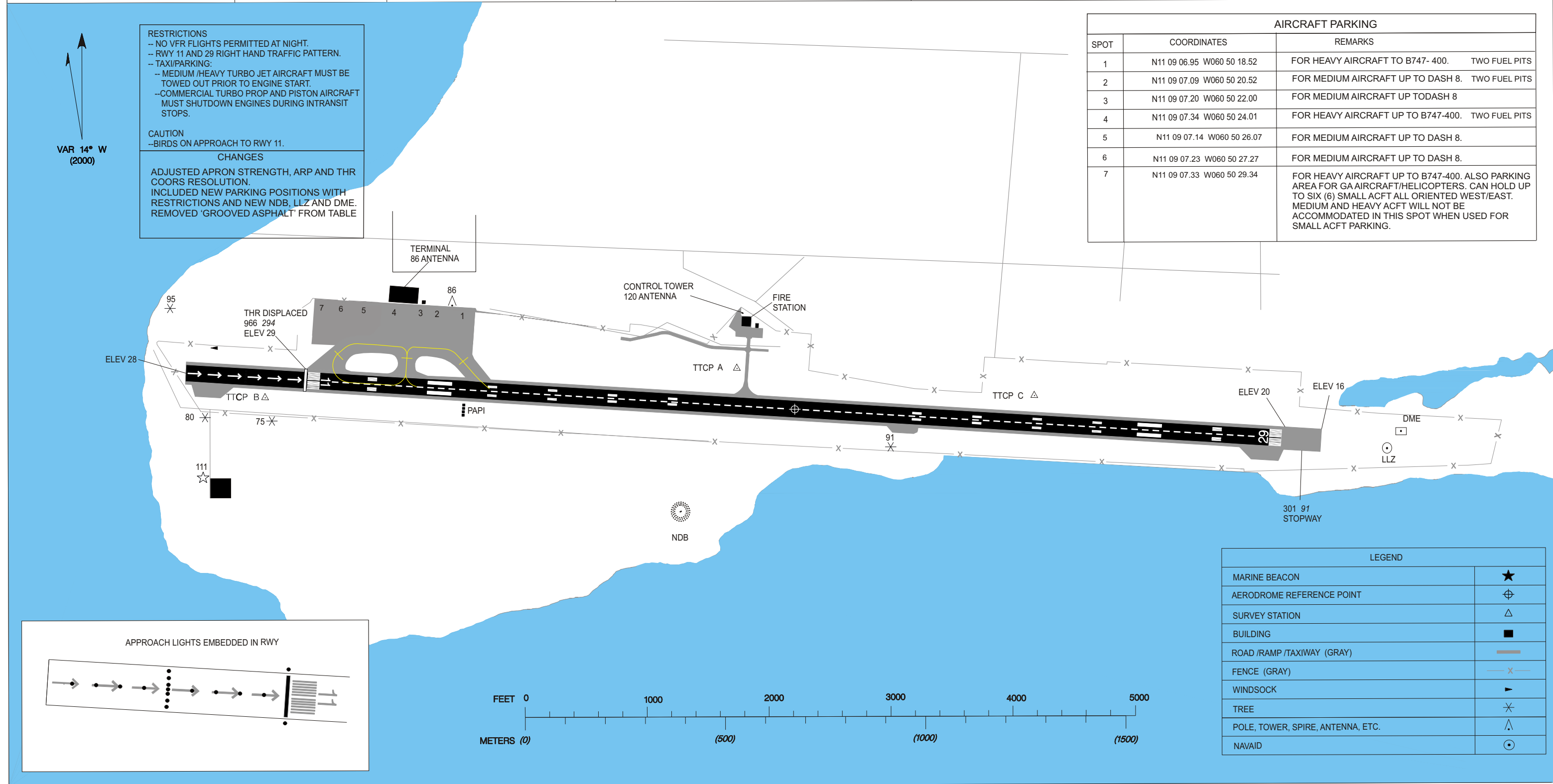

LEGEND	
MARINE BEACON	★
AERODROME REFERENCE POINT	⊕
SURVEY STATION	△
BUILDING	■
ROAD /RAMP /TAXIWAY (GRAY)	—
FENCE (GRAY)	—x—
WINDSOCK	▶
TREE	✕
POLE, TOWER, SPIRE, ANTENNA, ETC.	△
NAVAID	⊙

RWY	LIGHTING / RWY SURFACE	LANDING BEYOND		TAKE - OFF RUN AVAILABLE	WIDTH	THR COORDINATES	DIRECTION	BEARING STRENGTH
		THRESHOLD	GLIDE SLOPE					
11	HIRL SALS PAPI - R (3°)	8033 (2449)		8999 (2743)	148	N 11 09 01.39 W 060 50 31.40	109°	RWY: FIRST 4265 (1300) RWY 11- PCN 60/F/A/W/T REMAINING 4735 (1443) RWY 11- PCN 79/F/C/W/T TWY: PCN 60/F/A/W/T APRON: (EAST-PKG POS 1 TO 4) - PCN 59/R/A/W/T; (WEST-PKG POS 5 TO 7)- PCN 155/R/A/W/T
29	HIRL	8999 (2743)		8999 (2743)	(45)	N 11 08 55.56 W 060 49 10.92	289°	